



KONICA MINOLTA

# bizhub C654e

✍ Colour A3 multifunctional

✍ Up to 60/65 ppm in colour/black & white

## Functionality



- Colour
- Black & white

Copying



- Super G3 Fax
- PC-Fax
- i-Fax
- IP-Fax

Faxing



- Colour
- Black & white
- PCL/PS
- Local/Network
- USB

Printing



- Reprint
- Distribution
- Sharing
- Box-to-Box
- Box-to-USB

Box



- Colour
- Black & white
- Scan-to-eMail
- Scan-to-Me
- Scan-to-SMB
- Scan-to-Home
- Scan-to-FTP
- Scan-to-HDD
- Scan-to-Box
- Scan-to-USB
- Scan-to-WebDAV
- Scan-to-DPWS
- TWAIN Network

Scanning



## Technology



## Option diagram

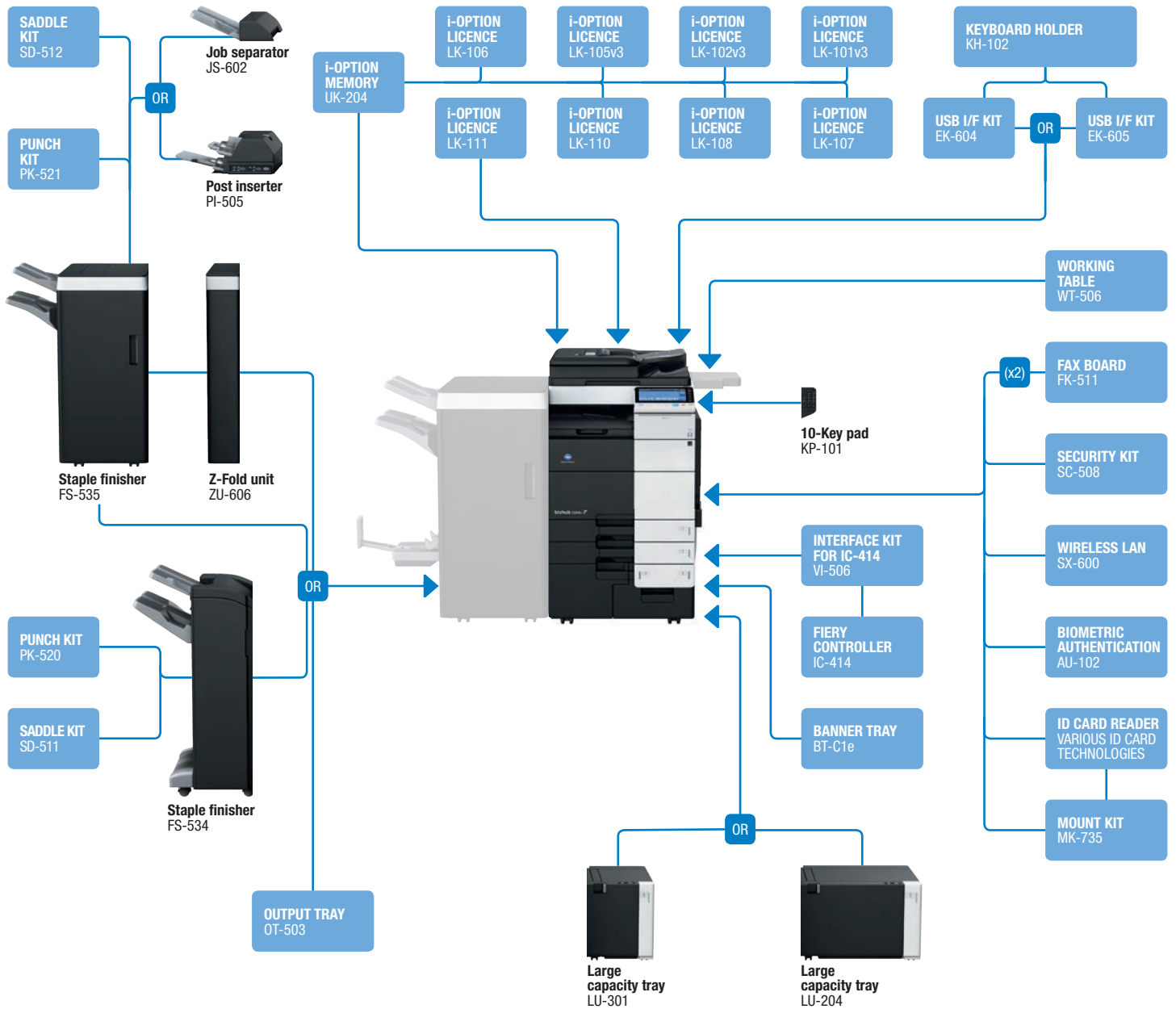

## Finishing options

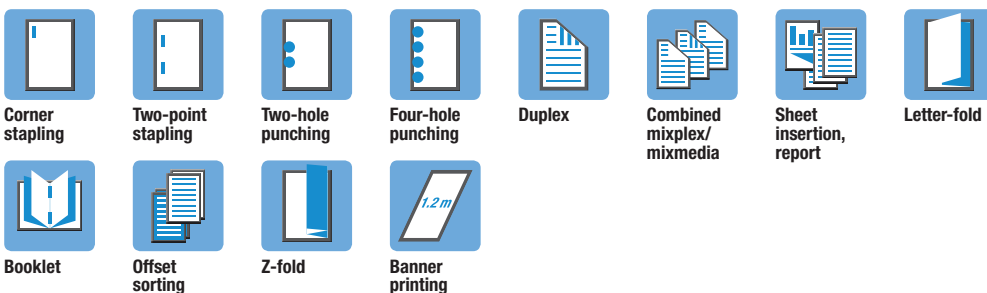

## Descriptions

<b>bizhub C654e</b>	Communication centre with 65 ppm b/w and 60 ppm colour. Standard Emperon™ print controller with PCL 5c; PCL 6, PostScript 3, PDF 1.7, OOXML and XPS support. Paper capacity of 500 + 500 + 1000 + 1500 sheets and 150-sheet manual bypass. Media from A6 to SRA3, 1.2 m banner and 52 – 300 gsm. 2 GB memory, 250 GB hard disc and Gigabit Ethernet standard
<b>LU-204 Large capacity tray</b>	A4–SRA3, 2,500 sheets, 52–256 gsm
<b>LU-301 Large capacity tray</b>	A4, 3,000 sheets, 52–256 gsm
<b>FS-534 Staple finisher</b>	50-sheet stapling, 3,300 sheets max. output
<b>PK-520 Punch kit for FS-534</b>	2/4 hole punching, autoswitching
<b>SD-511 Saddle kit for FS-534</b>	Booklet finishing, half-fold, letter-fold
<b>FS-535 Staple finisher</b>	100 sheets stapling, 3,200 sheets max. output
<b>PK-521 Punch kit for FS-535</b>	2/4 hole punching, autoswitching
<b>SD-512 Saddle kit for FS-535</b>	Booklet finishing, half-fold, letter-fold
<b>PI-505 Post inserter for FS-535</b>	Cover insertion, post finishing
<b>JS-602 Job separator for FS-535</b>	Separation for fax output etc.
<b>ZU-606 Z-fold unit for FS-535</b>	Z-fold for A3 prints, 2/4 hole punching
<b>OT-503 Output tray</b>	Output tray used instead of finisher
<b>KP-101 10-Key pad</b>	For use instead of touchscreen
<b>WT-506 Working table</b>	Authentication device placement

<b>FK-511 Fax board</b>	Super G3 fax, digital fax functionality
<b>IC-414 Fiery controller</b>	Professional colour print controller
<b>VI-506 Interface kit for IC-414</b>	Fiery controller interface card
<b>KH-102 Keyboard holder</b>	To place USB keyboard
<b>EK-604 USB I/F kit</b>	USB keyboard connection
<b>EK-605 USB I/F kit</b>	USB keyboard connection, Bluetooth
<b>ID card reader</b>	Various ID card technologies
<b>MK-735 Mount kit</b>	Installation kit for ID card reader
<b>AU-102 Biometric authentication</b>	Finger vein scanner
<b>SC-508 Security kit</b>	Copy Guard function (2 x required)
<b>BT-C1e Banner tray</b>	Multi-page banner feeding
<b>LK-101v3 i-Option licence</b>	Web browser
<b>LK-102v3 i-Option licence</b>	PDF/A, PDF encryption, digital signature
<b>LK-105v3 i-Option licence</b>	Searchable PDF and PPTX
<b>LK-106 i-Option licence</b>	Printing of barcode fonts
<b>LK-107 i-Option licence</b>	Printing of Unicode fonts
<b>LK-108 i-Option licence</b>	Printing of OCR (A and B) fonts
<b>LK-110 i-Option licence</b>	Generates various file formats incl. DOCX and XLSX
<b>LK-111 i-Option licence</b>	Native ThinPrint client
<b>UK-204 i-Option Memory</b>	Memory extension for i-Options
<b>SX-600 Wireless LAN</b>	Wireless LAN to network connector

## Technical specifications

### COPIER SPECIFICATIONS

<b>Copying process</b>	Electrostatic laser copy, tandem, indirect
<b>Toner system</b>	Simitri® HD polymerised toner
<b>Copy/print speed A4 (mono/colour)</b>	Up to 65 ppm Up to 60 ppm
<b>Copy/print speed A3 (mono/colour)</b>	Up to 33 ppm Up to 30 ppm
<b>Autoduplex speed A4 (mono/colour)</b>	Up to 65 ppm Up to 60 ppm
<b>1st copy out time (mono/colour)</b>	3.7 sec. 5.3 sec.
<b>Warm-up time</b>	Approx. 22 sec. <sup>1</sup>
<b>Copy resolution</b>	600 x 600 dpi
<b>Gradation</b>	256 gradations
<b>Multicopy</b>	1 – 9,999
<b>Original format</b>	A5 – A3
<b>Magnification</b>	25 – 400 % in 0.1 % steps; auto-zooming
<b>Copy functions</b>	Chapter; cover and page insertion; proof copy (print and screen); adjustment test print; digital art functions; job setting memory; poster mode; image repeat; overlay (optional); stamping; copy protection"

### PRINTER SPECIFICATIONS

<b>Print resolution</b>	1,800 x 600 dpi; 1,200 x 1,200 dpi
<b>Page description language</b>	PCL6 (XL 3.0); PCL 5c; PostScript 3 (CPSI 3016); XPS
<b>Operating systems</b>	Windows XP (32/64) Windows VISTA (32/64) Windows 7 (32/64) Windows 8 (32/64) Windows Server 2003 (32/64) Windows Server 2008 (32/64) Windows Server 2008 R2 (64) Windows Server 2012 (64) Macintosh OS X 10.x Unix, Linux, Citrix
<b>Printer fonts</b>	80 PCL Latin; 137 PostScript 3 Emulation Latin
<b>Print functions</b>	Direct print of PCL, PS, TIFF, XPS, PDF, encrypted PDF files and OOXML (DOCX, XLSX, PPTX); mixmedia and mixplex; "Easy Set" job programming; overlay; watermark; copy protection; carbon copy print

### PRINTER SPECIFICATIONS (OPTIONAL)

<b>Print controller</b>	Embedded Fiery IC-414
<b>Controller CPU</b>	Intel Pentium @ 2.6 GHz
<b>Memory/HDD</b>	2 GB/160 GB
<b>Page description language</b>	Adobe PostScript 3 (CPSI 3019) PCL 6/5c
<b>Operating systems</b>	Windows XP (32/64) Windows VISTA (32/64) Windows 7 (32/64) Windows 8 (32/64) Windows Server 2003 (32/64) Windows Server 2008 (32/64) Windows Server 2008 R2 (64) Windows Server 2012 (64) Macintosh OS 9.x/10.x

### SCANNER SPECIFICATIONS

<b>Scan speed (mono/colour)</b>	Up to 180 ipm
<b>Scan resolution</b>	Max.: 600 x 600 dpi
<b>Scan modes</b>	Scan-to-eMail (Scan-to-Me) Scan-to-SMB (Scan-to-Home) Scan-to-FTP Scan-to-Box Scan-to-USB Scan-to-WebDAV Scan-to-DPWS Network TWAIN scan
<b>File formats</b>	JPEG; TIFF; PDF; PDF/A 1a and 1b (optional); compact PDF; encrypted PDF; searchable PDF (optional); XPS; compact XPS; PPTX; searchable PPTX (optional); searchable DOCX/XLSX (optional)
<b>Scan destinations</b>	2,100 (single + group); LDAP support
<b>Scan functions</b>	Annotation (text/time/date) for PDF; up to 400 job programs; realtime scan preview

<sup>1</sup> Warm-up time may vary depending on the operating environment and usage

**FAX SPECIFICATIONS**

<b>Fax standard</b>	Super G3 (optional)
<b>Fax transmission</b>	Analogue i-Fax Colour i-Fax (RFC3949-C) IP-Fax
<b>Fax resolution</b>	Max.: 600 x 600 dpi (ultra-fine)
<b>Fax compression</b>	MH; MR; MMR; JBIG
<b>Fax modem</b>	Up to 33.6 Kbps
<b>Fax destinations</b>	2,100 (single + group)
<b>Fax functions</b>	Polling; time shift; PC-Fax; receipt to confidential box; Receipt to e-mail/FTP/SMB; up to 400 job programs

**USER BOX SPECIFICATION**

<b>Max. storable documents</b>	Up to 3,000 documents or 10,000 pages
<b>Type of user boxes</b>	Public Personal (with password or authentication) Group (with authentication)
<b>Type of system boxes</b>	Secure print Encrypted PDF print Fax receipt Fax polling
<b>User box functionality</b>	Reprint; combination Download Sending (e-mail/FTP/SMB and fax) Copy box to box

**SYSTEM SPECIFICATIONS**

<b>System memory</b>	2,048 MB (standard)
<b>System hard disc</b>	250 GB (standard)
<b>Interface</b>	10-Base-T/100-Base-T/1,000-Base-T Ethernet; USB 2.0
<b>Network protocols</b>	TCP/IP (IPv4 / IPv6); IPX/SPX; NetBEUI; AppleTalk (EtherTalk); SMB; LPD; IPP; SNMP; HTTP
<b>Frame types</b>	Ethernet 802.2; Ethernet 802.3; Ethernet II; Ethernet SNAP
<b>Automatic document feeder</b>	Up to 150 originals; A6-A3; 35-210 gsm Dualscan ADF
<b>Printable paper size</b>	A6-SRA3, customised paper sizes; banner paper max. 1,200 x 297 mm
<b>Printable paper weight</b>	52-300 gsm
<b>Paper input capacity</b>	Standard: 3,650 sheets Max.: 6,650 sheets*
<b>Tray 1</b>	500 sheets, A5-SRA3, 52-256 gsm
<b>Tray 2</b>	500 sheets, A5-SRA3, 52-256 gsm
<b>Tray 3</b>	1,500 sheets, A4, 52-256 gsm
<b>Tray 4</b>	1,000 sheets, A4, 52-256 gsm
<b>Large capacity cabinet 1 (optional)</b>	3,000 sheets, A4, 52-256 gsm
<b>Large capacity cabinet 2 (optional)</b>	2,500 sheets, A4-SRA3, 52-256 gsm
<b>Manual bypass</b>	150 sheets, A6-SRA3, custom sizes, banner, 52-300 gsm
<b>Automatic duplexing</b>	A5-SRA3; 52-256 gsm
<b>Finishing modes (optional)</b>	Offset; group; sort; staple; punch; post insertion; z-fold; centre-fold; letter fold; booklet
<b>Output capacity (with finisher)</b>	Max.: 3,300 sheets
<b>Output capacity (without finisher)</b>	Max.: 250 sheets

<b>Stapling</b>	Max.: 100 sheets or 98 sheets + 2 cover sheets (up to 209 gsm)
<b>Stapling output capacity</b>	Max.: 1,000 sheets
<b>Letter fold</b>	Up to 3 sheets
<b>Letter fold capacity</b>	Max.: 30 sheets (tray); unlimited
<b>Booklet</b>	Max.: 20 sheets or 19 sheets + 1 cover sheet (up to 209 gsm)
<b>Booklet output capacity</b>	Max.: 100 sheets (tray); unlimited
<b>Copy/print volume (monthly)</b>	Rec.: 125,000 pages Max.: 250,000 pages
<b>Toner lifetime</b>	Black 47,200 pages; CMY 31,500 pages
<b>Imaging unit lifetime</b>	Black 300,000 pages/1,200,000 pages (Drum/Developer) CMY 155,000 pages
<b>Power consumption</b>	220-240 V / 50/60 Hz Less than 2,1 kW (system)
<b>System dimensions (W x D x H)</b>	650 x 799 x 1,155 mm
<b>System weight</b>	Approx. 221 kg

**SYSTEM FEATURES**

<b>Security</b>	ISO 15408 EAL3 (in evaluation); IP filtering and port blocking; SSL2; SSL3 and TLS1.0 network communication; IPsec support; IEEE 802.1x support; user authentication; Authentication log; secure print; Hard disc overwrite (8 standard types); Hard disc data encryption (AES 128); Memory data auto deletion; Confidential fax receipt; Print user data encryption; copy protection (Copy Guard, Password Copy) optional
<b>Accounting</b>	Up to 1,000 user accounts; Active Directory support (user name + password + e-mail + smb folder) User function access definition Biometric authentication (finger vein scanner) optional ID card authentication (ID card reader) optional*
<b>Software</b>	PageScope Net Care Device Manager PageScope Data Administrator PageScope Box Operator PageScope Direct Print Print Status Notifier Driver Packaging Utility Log Management Utility

- All specifications refer to A4-size paper of 80 gsm quality.
- The support and availability of the listed specifications and functionalities varies depending on operating systems, applications and network protocols as well as network and system configurations.
- The stated life expectancy of each consumable is based on specific operating conditions such as page coverage for a particular page size (5% coverage of A4). The actual life of each consumable will vary depending on use and other printing variables including page coverage, page size, media type, continuous or intermittent printing, ambient temperature and humidity.
- Some of the product illustrations contain optional accessories.
- Specifications and accessories are based on the information available at the time of printing and are subject to change without notice.
- Konica Minolta does not warrant that any specifications mentioned will be error-free.
- All brand and product names may be registered trademarks or trademarks of their respective holders and are hereby acknowledged.

